



WWW.BARRACUDA-CONDOS.COM



refrigerator



under counter  
wine refrigerator



range option #1  
induction



range option #2  
gas



dishwasher



microwave



range hood



**SUB-ZERO APPLIANCES**

CONTACT:  
LIZ LAUER: 608.444.5725  
MARK GLADUE: 608.658.0467  
[info@lauerrealtygroup.com](mailto:info@lauerrealtygroup.com)  
Lauer Realty Group  
2229 Atwood Ave  
Madison, WI 53704



## 648PROG



## FEATURES

Dual refrigeration, plus a third evaporator dedicated just to the roomy crisper drawers

Clear-view, triple-pane and UV-resistant glass door

Over 30 cu. ft. of storage (18.5 refrigerator, 11.7 freezer)

Microprocessor control for peak performance

Stainless steel construction for decades of use

"Soft bright" interior lighting for superior visibility

Automatic ice maker with advanced water filtration system

Exterior temperature display for easy reading

Rigorously tested in our U.S. manufacturing facilities to ensure decades of use

Exceptional 24/7 support from Madison, WI-based Customer Care team

Easy-sliding bins

Tough-and-glide crisper drawer seals tight

Adjustable shelves and dividers for flexible organization

Auto-close door for maximum refrigeration

Flip-up grille for easy maintenance access

## ACCESSORIES

Egg Container

Refrigerator Drawer Dividers

Slide Out Bin

Water Filter 4204490

90° door stop

Stainless steel front and side kickplates

Stainless steel slide-out refrigerator bin

Stainless steel side panels and top for freestanding application

Replacement water filter

Accessories are available through an authorized dealer.  
For local dealer information, visit [subzero-wolf.com/locator](http://subzero-wolf.com/locator).



## PRODUCT DETAILS

## REFRIGERATOR

- One glass crisper lid
- One stationary glass shelf
- Two adjustable stainless steel slide-out bins
- Three adjustable glass shelves
- Interchangeable drawer dividers

## FREEZER

- One stationary stainless steel shelf
- Three adjustable stainless steel shelves
- Stainless steel ice bucket
- Automatic ice maker

**PRODUCT SPECIFICATIONS**

|                       |                          |
|-----------------------|--------------------------|
| Model                 | 648PROG                  |
| Dimensions            | 48"W x 84"H x 24"D       |
| Door Clearance        | 30 3/4"                  |
| Weight                | 875 lbs                  |
| Refrigerator Capacity | 18.5 cu. ft.             |
| Freezer Capacity      | 11.7 cu. ft.             |
| Electrical Supply     | 115 VAC, 60 Hz           |
| Electrical Service    | 15 amp dedicated circuit |
| Receptacle            | 3-prong grounding-type   |

**ELECTRICAL**

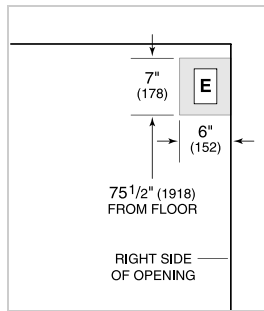

**PLUMBING**

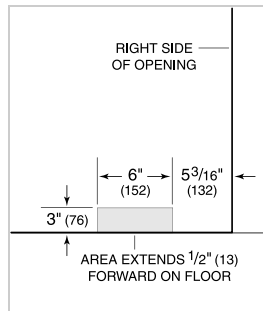

**NOTE:** Dimensions in parenthesis are in millimeters unless otherwise specified

**INTERIOR VIEW**

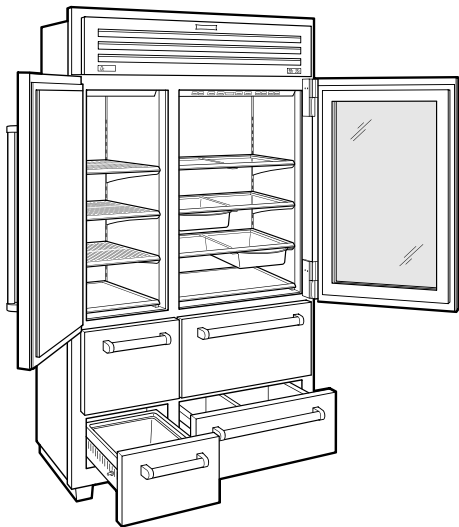

This illustration is intended for interior reference only and may not represent the exterior of the model being specified.

**DIMENSIONS**

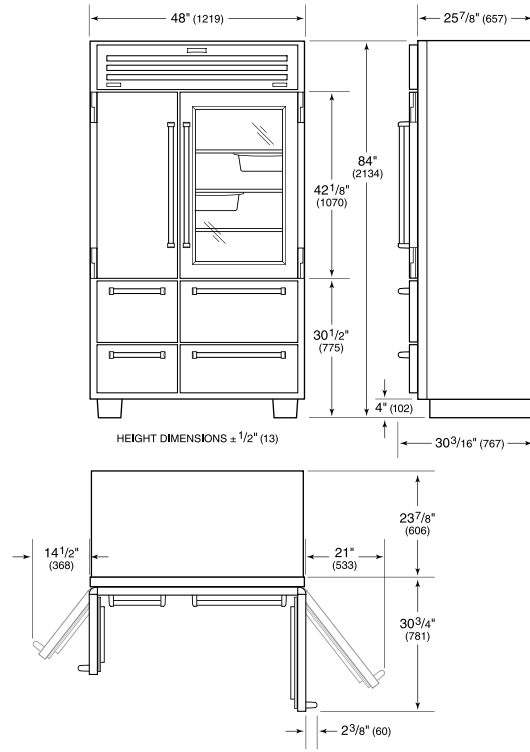

**STANDARD INSTALLATION**

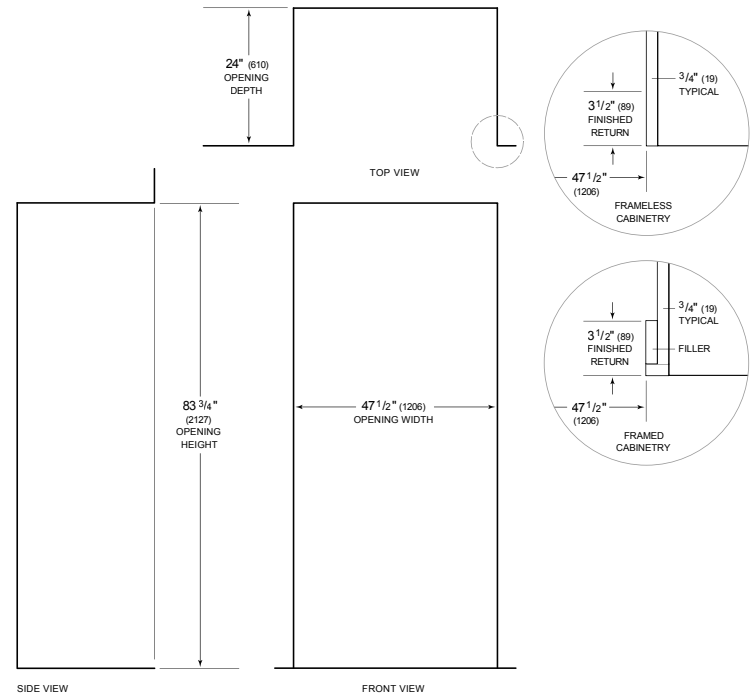

**NOTE:** 3 1/2" (89) finished returns will be visible and should be finished to match cabinetry

UW-24/S



## FEATURES

Stainless steel for a classic Sub-Zero look

Two independent temperature zones hold reds and whites at proper serving temperature

Dual evaporators for constant, moderate humidity so corks don't dry out

Textured roller-glide shelves for access without agitating wine

UV-resistant glass door protects against premature wine aging

Intuitive control panel keeps temps within one degree of set point

Brighter LED lighting makes finding bottles easy

Inventory tile system for better organization

Rigorously tested in our U.S. manufacturing facilities to ensure decades of use

Exceptional 24/7 support from Madison, WI-based Customer Care team

## ACCESSORIES

Dual Installation Kit

Undercounter Black Dual Kickplate

Undercounter Door Lock Kit

Undercounter Silver Dual Kickplate

Undercounter Silver Kickplate

Undercounter Solid Overlay Door

Wine inventory tiles

Wine inventory tiles-writable

Accessories are available through an authorized dealer.  
For local dealer information, visit [subzero-wolf.com/locator](http://subzero-wolf.com/locator).

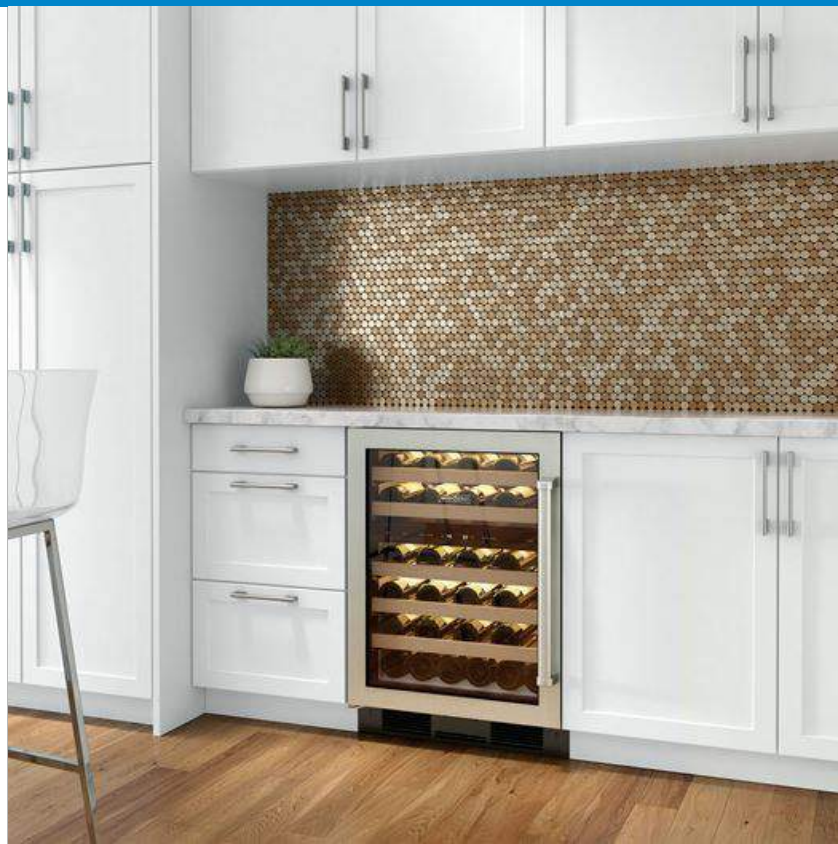

## HANDLE OPTIONS

PRO



TUBULAR



**PRODUCT SPECIFICATIONS**

|                       |                          |
|-----------------------|--------------------------|
| Model                 | UW-24/S                  |
| Dimensions            | 23 7/8"W x 34"H x 24"D   |
| Door Clearance        | 25 3/8"                  |
| Weight                | 195 lbs                  |
| Electrical Supply     | 115 VAC, 60 Hz           |
| Electrical Service    | 15 amp dedicated circuit |
| Wine Storage Capacity | 46 Bottles               |
| Receptacle            | 3-prong grounding-type   |

**ELECTRICAL**

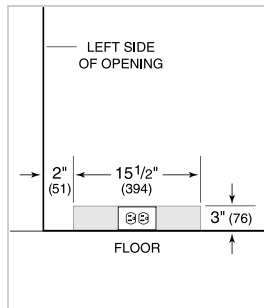

NOTE: Dimensions in parenthesis are in millimeters unless otherwise specified

**INTERIOR VIEW**

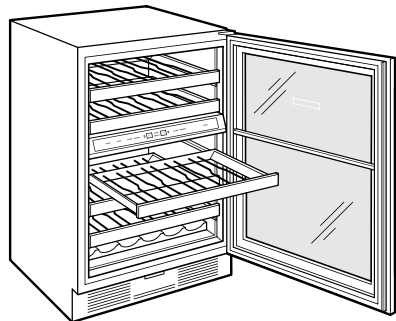

This illustration is intended for interior reference only and may not represent the exterior of the model being specified.

**DIMENSIONS**

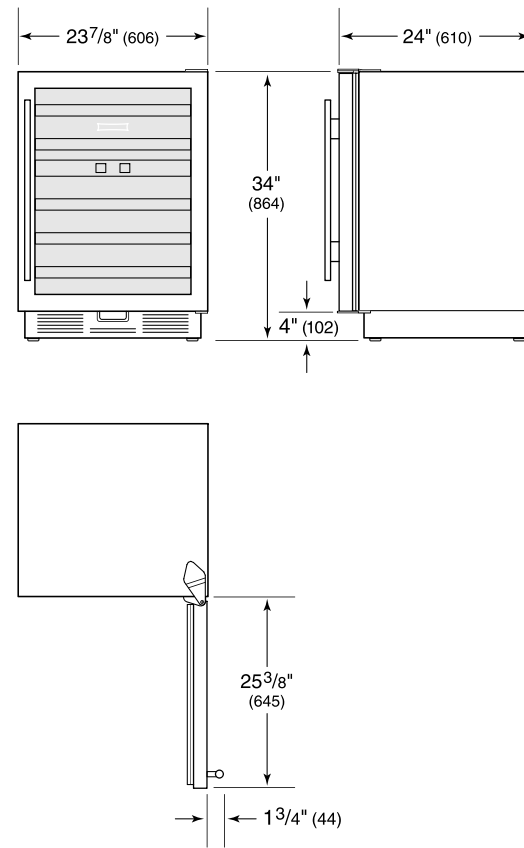

**STANDARD INSTALLATION**

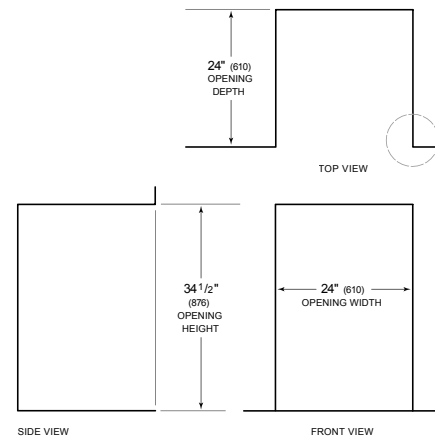

NOTE: 3 1/2" (89) finished returns will be visible and should be finished to match cabin

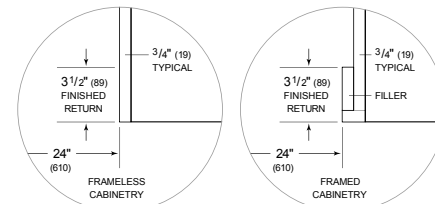

DF364G



## FEATURES

- 10 cooking modes make meals easy

---

- Dual convection oven for faster, more consistent cooking

---

- 4 dual-stacked burners plus 15,000 Btu infrared griddle

---

- Dual-stacked burners produce up to 20,000 Btu

---

- Burners capable of delivering less than 300 Btu for premier simmer performance

---

- Continuous cast-iron grates for easy movement of pots and pans

---

- Rigorously tested in our U.S. manufacturing facilities for decades of use

---

- Exceptional 24/7 support from our Customer Care team in Madison

---

- Cobalt blue porcelain interior

---

- Spark ignition system re-ignites if flame goes out

---

- Heavy-gauge stainless steel

---

- Exclusive pivoting control panel

---

- Red, black or stainless steel control knobs

---

- Temperature probe cooks to ideal doneness and lets you know when it's ready

---

- Self clean, delayed start, timed cook, Sabbath mode and more

## ACCESSORIES

- 11" Cutting Board

---

- 2-Burner Wok Grate

---

- 3 3/4" (95) Front Leg Covers

---

- 30" Broiler Pan

---

- 36" Bake Stone Kit

---

- 36" Full-extension ball-bearing oven rack

---

- 36" Stainless Steel Kickplate

---

- Dehydration Kit

---

- Griddle Cleaning Pads

---

- Griddle Cleaning Kit

---

- Griddle Cleaning Solution

---

- Oven Rack Set (3)

---

- S-Grates

---

- Temperature Probe

---

- Stainless steel, brass or chrome bezels

---

- 5" and 10" stainless steel risers, and 20" riser with shelf

Accessories available through an authorized dealer.  
For local dealer information, visit [subzero-wolf.com/locator](http://subzero-wolf.com/locator).



## KNOB OPTIONS



## TOP CONFIGURATION

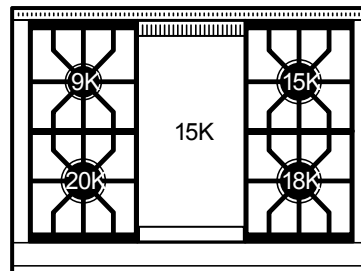

## RANGETOP SPECIFICATIONS

- 1 - 9,200 Btu Burner
- 1 - 15,000 Btu Burner
- 1 - 18,000 Btu Burner
- 1 - 20,000 Btu Burner
- 1 - 15,000 Btu (14,000 Btu LP) Griddle



## PW362210

### FEATURES

- Heavy-duty stainless steel construction
- Handfinished with hemmed edges and welded seams
- Bright halogen lighting
- Infinite speed blower control
- Heat sentry for safety
- Recessed controls for sleeker look
- Blower required (internal, in-line or remote blowers available)
- Rigorously tested in our U.S. manufacturing facilities for decades of use
- Exceptional 24/7 support from our Customer Care team in Madison

### ACCESSORIES

- Backsplash
- Backsplash with Warming Racks
- Make-Up Air Damper
- Inline Blowers
- Internal Blowers
- Remote Blowers
- Pro Wall Hood Duct Covers
- Recirculating kit and filter for non-ducted applications (internal blower)

Accessories available through an authorized dealer.  
For local dealer information, visit [subzero-wolf.com/locator](http://subzero-wolf.com/locator).



### BLOWER OPTIONS

- 500 CFM Internal
- 600 CFM Inline
- 1100 CFM Inline
- 600 CFM Remote
- 900 CFM Remote
- 1200 CFM Remote
- 1500 CFM Remote

## PRODUCT SPECIFICATIONS

|                              |                          |
|------------------------------|--------------------------|
| Model                        | PW362210                 |
| Dimensions                   | 36"W x 10"H x 22"D       |
| Weight                       | 44 lbs                   |
| Electrical Supply            | 110/120 VAC, 60 Hz       |
| Electrical Service           | 15 amp dedicated circuit |
| Discharge Location           | Vertical or Horizontal   |
| Discharge Dimensions         | Rectangle 14" x 3 1/4"   |
| Bottom of Hood to Countertop | 30" to 36"               |

**NOTE:** Dimensions in parenthesis are in millimeters unless otherwise specified

## DIMENSIONS

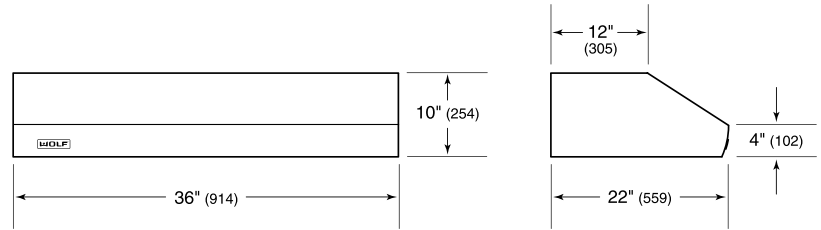

IR365TE/S/TH



**FEATURES**

- \_\_\_\_\_ Magnetic induction technology provides fast and perfectly distributed heat
- \_\_\_\_\_ Incredible cooking control, with lightning fast high heat and very low lows
- \_\_\_\_\_ Five induction zones and multiple bridging options to accommodate different pan sizes
- \_\_\_\_\_ Cookware sensing guards against hot burners being left on
- \_\_\_\_\_ Dual convection oven for faster, more consistent cooking
- \_\_\_\_\_ Temperature probe cooks to ideal doneness and lets you know when it's ready
- \_\_\_\_\_ Cobalt blue porcelain interior
- \_\_\_\_\_ Red, black or brushed stainless control knobs
- \_\_\_\_\_ Self clean, delayed start, timed cook, Sabbath mode and more
- \_\_\_\_\_ 10 cooking modes make meals easy
- \_\_\_\_\_ Rigorously tested in our U.S. manufacturing facilities for decades of use
- \_\_\_\_\_ Exceptional 24/7 support from our Customer Care team in Madison

**ACCESSORIES**

- \_\_\_\_\_ 30" Broiler Pan
- \_\_\_\_\_ 36" Bake Stone Kit
- \_\_\_\_\_ 36" Full-extension ball-bearing oven rack
- \_\_\_\_\_ 36" Stainless Steel Kickplate
- \_\_\_\_\_ 5" Stainless Steel Riser
- \_\_\_\_\_ Dehydration Kit
- \_\_\_\_\_ Oven Rack Set (3)
- \_\_\_\_\_ Temperature Probe
- \_\_\_\_\_ Induction Range Knobs
- \_\_\_\_\_ Rear Caster Covers
- \_\_\_\_\_ Front Leg Extension Covers

Accessories available through an authorized dealer.  
 For local dealer information, visit [subzero-wolf.com/locator](http://subzero-wolf.com/locator).



**KNOB OPTIONS**



**TOP CONFIGURATION**

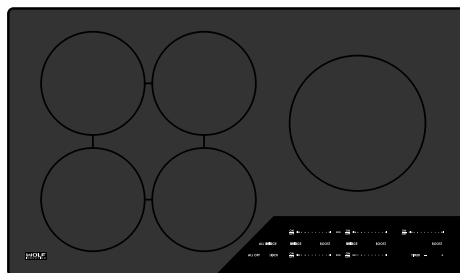

**PRODUCT SPECIFICATIONS**

|                            |                                |
|----------------------------|--------------------------------|
| Model                      | IR365TE/S/TH                   |
| Dimensions                 | 35 7/8"W x 35 7/8"H x 29 1/2"D |
| Oven 1 Interior Dimensions | 30"W x 16 1/2"H x 19"D         |
| Oven 1 Usable Capacity     | 3.5 cu. ft.                    |
| Oven 1 Overall Capacity    | 5.4 cu. ft.                    |
| Door Clearance             | 19 1/2"                        |
| Weight                     | 470 lbs                        |
| Electrical Supply          | 240/208 VAC, 60 Hz             |
| Electrical Service         | 50 amp dedicated service       |

**ELECTRICAL**

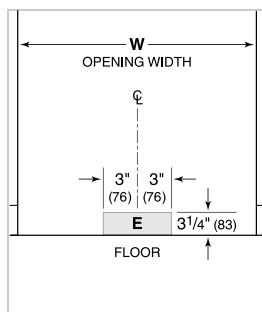

**IMPORTANT NOTE:** Adjacent countertops must be at least 35 7/8" for flush installation to top of unit.

**NOTE:** Dimensions in parenthesis are in millimeters unless otherwise specified

**DIMENSIONS**

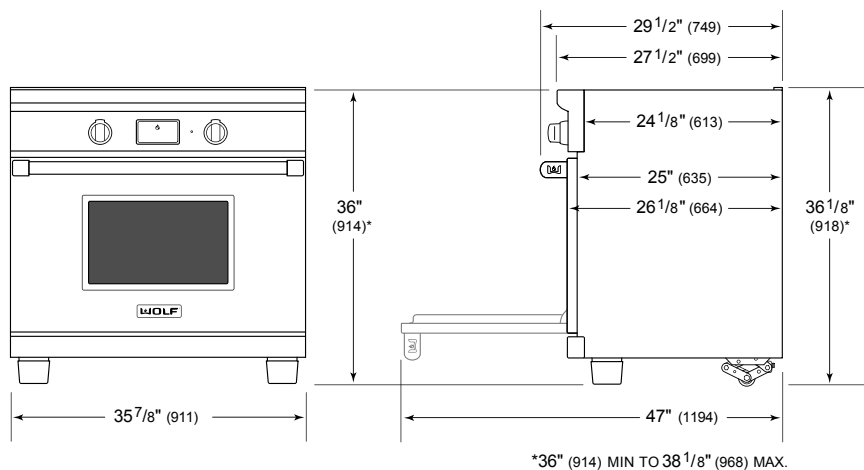

**STANDARD INSTALLATION**

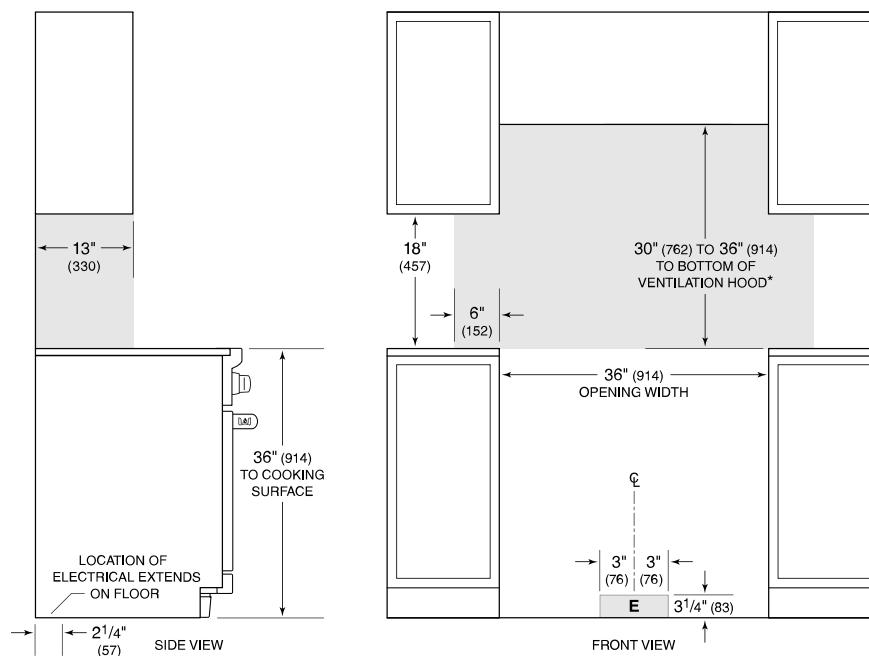

*\*Without ventilation hood, 36" (914) minimum clearance countertop to combustible materials.*  
**NOTE:** Shaded area above countertop indicates minimum clearance to combustible surfaces, combustible materials cannot be located within this area.  
 For island installation, 12" (305) minimum clearance back of range to combustible rear wall above countertop.

## MS 24

### FEATURES

Gourmet mode cooks automatically from preset recipes

Quick-start controls for popular items

"Keep Warm" mode

Use freestanding or built into cabinetry

Sleek, black glass design

1200 watts of power

Rigorously tested in our U.S. manufacturing facilities for decades of use

Exceptional 24/7 support from our Customer Care team in Madison

Installs standard or flush inset

### ACCESSORIES

Trim Kits - M Series

Trim Kits - E Series

Trim Kits - L Series

Accessories available through an authorized dealer.

For local dealer information, visit [subzero-wolf.com/locator](http://subzero-wolf.com/locator).



### TRIM OPTIONS

#### E SERIES STAINLESS



#### E SERIES BLACK



#### M SERIES STAINLESS



#### M SERIES BLACK



## PRODUCT SPECIFICATIONS

|                    |                          |
|--------------------|--------------------------|
| Model              | MS24                     |
| Capacity           | 2 cu. ft.                |
| Weight             | 50 lbs                   |
| Electrical Supply  | 120 VAC, 60 Hz           |
| Electrical Service | 15 amp dedicated circuit |
| Power Cord Length  | 4 Feet                   |
| Receptacle         | 3-prong grounding-type   |

## ELECTRICAL

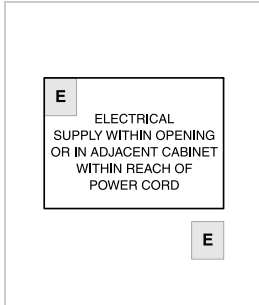

**INSTALLATIONS WITH ACCESSORY TRIM** Accessory trim may affect overall product dimensions and opening dimensions. Refer to [Reveal](http://subzero-wolf.com/reveal) for more information: [subzero-wolf.com/reveal](http://subzero-wolf.com/reveal)

**NOTE:** Dimensions in parenthesis are in millimeters unless otherwise specified

## DIMENSIONS

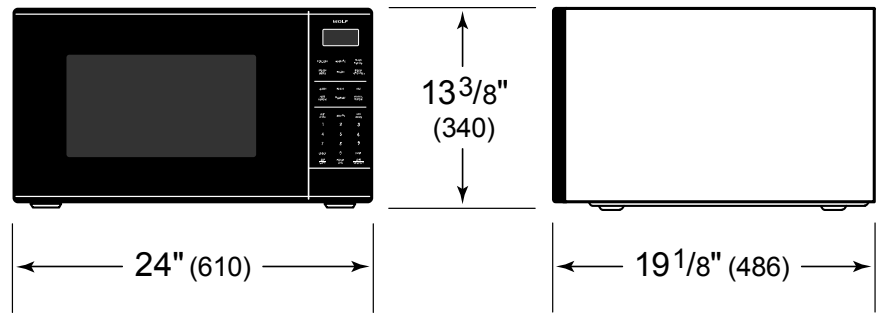

DW2450



## FEATURES

Custom wash and dry options and three separate spray arms to ensure optimal cleaning performance

Height-adjustable middle rack and fold-down tines adjust to any size or combination of dishes

Accepts cabinet panels for a custom look or stainless panels and handles to match Sub-Zero and Wolf products

Near-silent operation never interrupts the conversation

Easy-to-use, touch controls and display are hidden to maintain clean lines and a status floor light indicates cycle status

LED lit interior for better interior visibility

Rigorously tested in our U.S. manufacturing facilities to ensure decades of use

Exceptional 24/7 support from Madison, WI-based Customer Care team

## ACCESSORIES

Pro Handle

Tubular Handle

24" Stainless Steel Door Panels

60cm Stainless Steel Door Panels

24" Stainless Steel Kickplates

60cm Stainless Steel Kickplates

Accessories are available through an authorized dealer.  
For local dealer information, visit [subzero-wolf.com/locator](http://subzero-wolf.com/locator).



## HANDLE ACCESSORIES

PRO



TUBULAR



**PRODUCT SPECIFICATIONS**

|                    |  |
|--------------------|--|
| Model              | DW2450   |
| Dimensions         | 23 5/8"W x 34 1/2"H x 23 1/4"D                         |
| Door Clearance     | 26 3/4"  |
| Electrical Supply  | 115 VAC, 60 Hz   |
| Electrical Service | 15 amp dedicated circuit                               |
| Receptacle         | 3-prong grounding-type                                 |
| Cord Length        | 3'   |
| Water Connection   | 5' braided tubing with 3/8" female compression fitting |
| Drain Connection   | 5' (1.5 m) corrugated tubing                           |
| Plumbing Pressure  | 30–140 psi   |

**ELECTRICAL**

**PLUMBING**

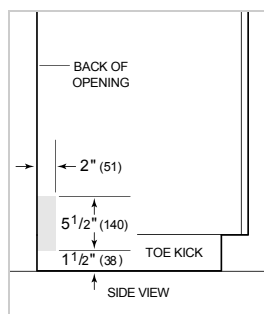
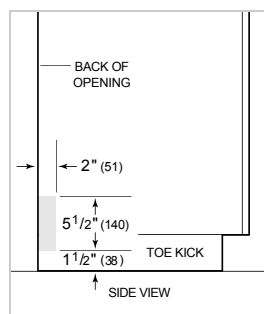

**NOTE:** Dimensions in parenthesis are in millimeters unless otherwise specified

**PANEL SPECIFICATIONS** For complete panels specifications including width/height, weight requirements and thickness requirements visit [subzero-wolf.com/reveal](http://subzero-wolf.com/reveal).

**INTERIOR VIEW**

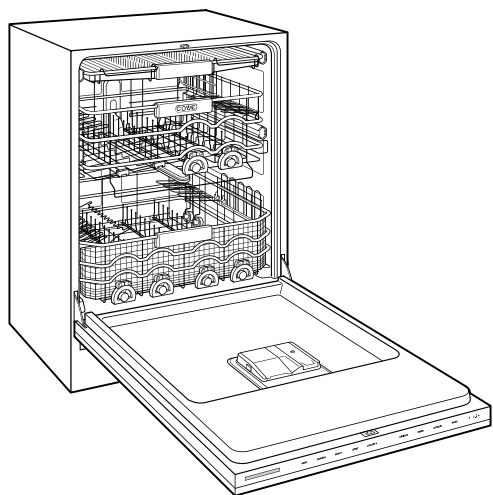

This illustration is intended for interior reference only and may not represent the exterior of the model being specified.

**DIMENSIONS**

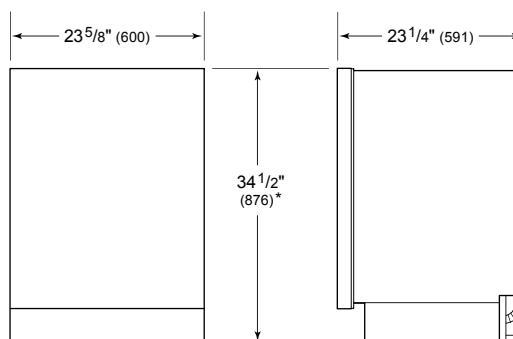

\*34" (864) MIN TO 34 5/8" (880) MAX

